

8 7 6 5 4 3 2 1

REVISIONS			
REV.	BY:	DESCRIPTION	DATE
-	CAS	INITIAL RELEASE	1-28-97
A	GEIDEL	REVISED PER ECO # 1463	7-9-98
B	NATHAN	REVISED PER ECO # 1801	8-5-99

REQUEST FOR APPROVAL

RETURN ONE COPY TO RJR WITH APPROVAL SIGNATURE

BY: _____

DATE: _____

RJR POLYMERS INC.

SUBMIT DATE: _____

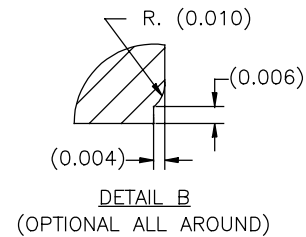
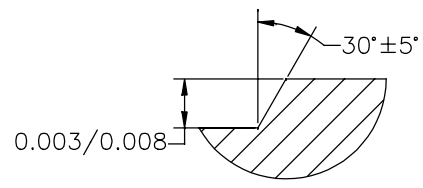
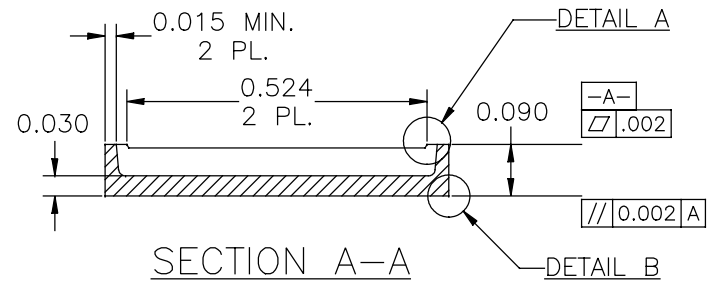
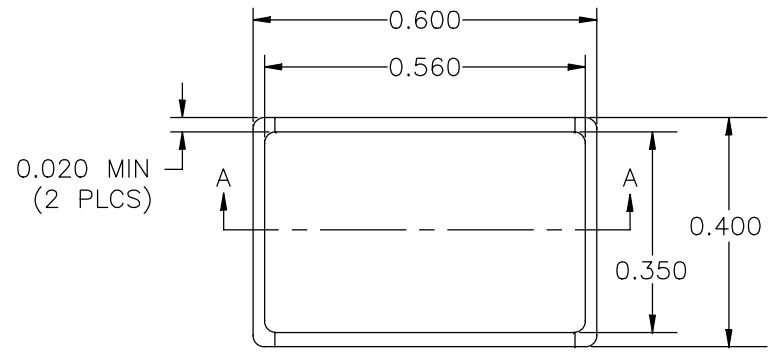

NOTES: (UNLESS OTHERWISE SPECIFIED)
 1. PART TO BE FREE OF SHARP EDGES AND BURRS.

TOLERANCES ARE IN INCHES:
 (UNLESS OTHERWISE SPECIFIED)
 FRACTIONS: ±1/16"
 DECIMALS: X.XX = ±0.01
 X.XXX = ±0.005
 √ ±1
 √ ±1/32"/FT.
 √ 0.003"/IN.
 DRAFT ≤ 10° MAX.
 RADII = R 0.020 MAX

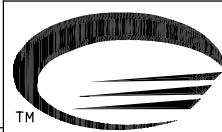

THIS DRAWING CONTAINS INFORMATION THAT IS CONFIDENTIAL AND PROPRIETARY PROPERTY OF R.J.R. POLYMERS, INC., AND ITS DESIGN, DETAIL AND INVENTION, ARE THE PROPERTY OF R.J.R. POLYMERS, INC., SUBMITTED TO THE RECIPIENT IN CONFIDENCE AND SHALL NOT BE COPIED IN ANY MANNER NOR DISCLOSED TO ANY OUTSIDE PARTY WITHOUT THE EXPRESS WRITTEN CONSENT OF AN AUTHORIZED OFFICER OF THIS COMPANY. THEY SHALL BE USED EXCLUSIVELY FOR REFERENCE WORK ON CONTRACTS OR PROPOSALS SUBMITTED BY R.J.R. POLYMERS, INC. AND SHALL BE RETURNED ON REQUEST. THIS DRAWING MUST BE KEPT ONLY IN THE CONFIDENTIAL FILES OF R.J.R. POLYMERS, INC., WHEN NOT IN USE. ALL RIGHTS RESERVED.

RJR POLYMERS, INC
 7875 EDGEWATER DR., OAKLAND, CA. 94621

QTY	ITEM	MATERIAL
-	-	WHITE, ALUMINA, 96% MIN

CADFILE: Q: \Drawings\... \1866B.DWG		0.600 X 0.400 X 0.090	
CLIENT #		WHITE CERAMIC LID	
DATE 8-5-99	SCALE NTS	DRAWN BY NATHAN	DWG SIZE A
CHECKED BY	PART/DWG # 1866	REV B	1/1

8 7 6 5 4 3 2 1