

REVISIONS		
REV.	DESCRIPTION	DATE
NC	RELEASED: CAS	5-15-96
A	REMOVE GD&T	8-11-98
B	ADD WIDTH I.D., CHANGE DRAFT ANGLE AND WALL RADII	9-9-98

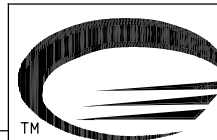
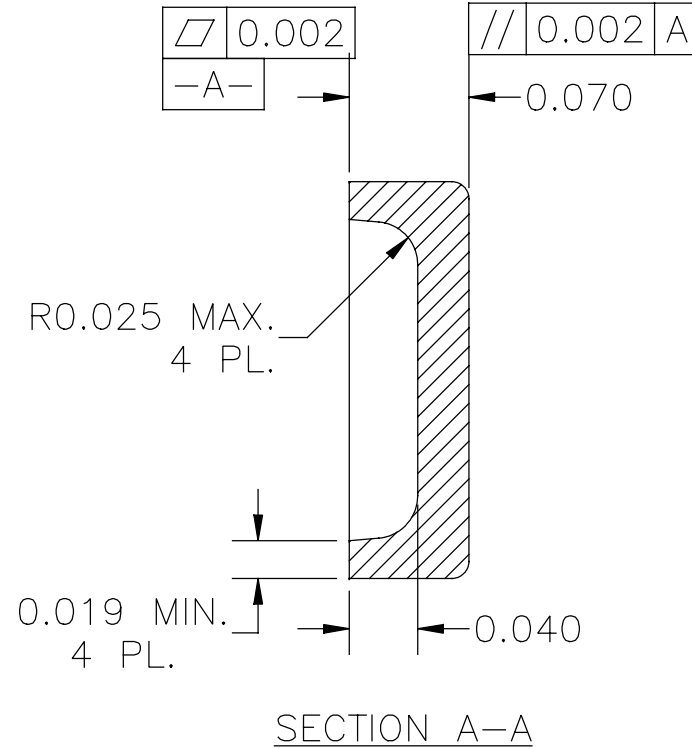
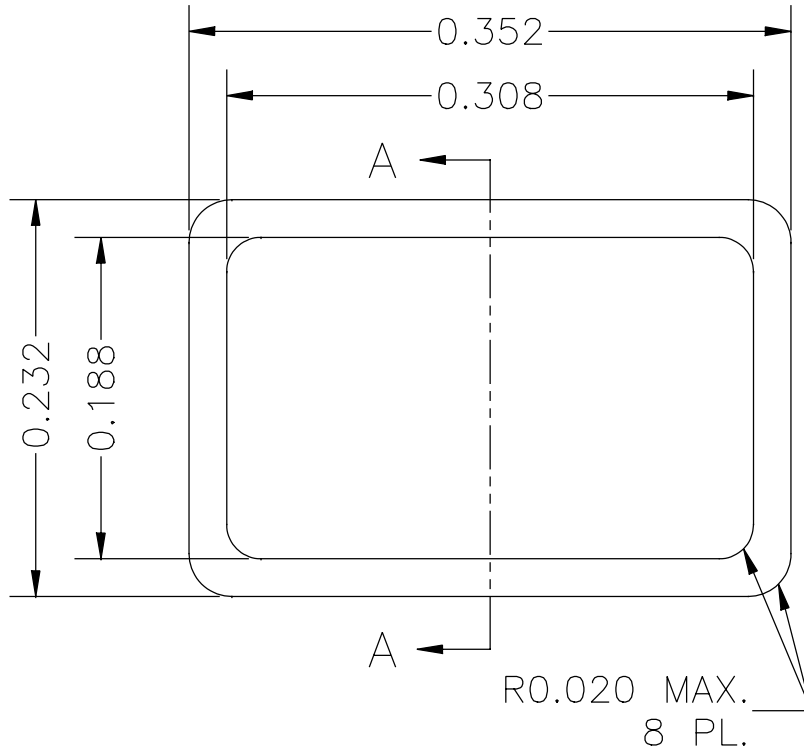

THIS DRAWING CONTAINS INFORMATION THAT IS CONFIDENTIAL AND PROPRIETARY PROPERTY OF R.J.R. POLYMERS, INC., AND ITS DESIGN, DETAIL AND INVENTION, ARE THE PROPERTY OF R.J.R. POLYMERS, INC., SUBMITTED TO THE RECIPIENT IN CONFIDENCE AND SHALL NOT BE COPIED IN ANY MANNER NOR DISCLOSED TO ANY OUTSIDE PARTY WITHOUT THE EXPRESS WRITTEN CONSENT OF AN AUTHORIZED OFFICER OF THIS COMPANY. THEY SHALL BE USED EXCLUSIVELY FOR REFERENCE WORK ON CONTRACTS OR PROPOSALS SUBMITTED BY R.J.R. POLYMERS, INC. AND SHALL BE RETURNED ON REQUEST. THIS DRAWING MUST BE KEPT ONLY IN THE CONFIDENTIAL FILES OF R.J.R. POLYMERS, INC., WHEN NOT IN USE. ALL RIGHTS RESERVED.

RJR POLYMERS, INC  
7875 EDGEWATER DR., OAKLAND, CA. 94621

CADFILE:  
E:\Part # Files\...\2033  
CLIENT #

0.352 x 0.232 x 0.070

CERAMIC LID

CS-12

TOLERANCES ARE IN INCHES:  
(UNLESS OTHERWISE SPECIFIED)  
FRACTIONS:  $\pm 1/16"$   
DECIMALS: X.XX =  $\pm 0.01$   
              X.XXX =  $\pm 0.003$   
 $\angle \pm 1^\circ$   
 $\square \pm 1/32" / FT.$   
 $\square 0.003" / IN.$   
DRAFT  $\leq 15^\circ$  MAX.  
RADII: 0.015 MAX.

DATE	SCALE	DRAWN BY	DWG SIZE	CHECKED BY	PART/DWG #	REV	
9/9/98	NTS	DMG	A		2033	B	1/1

QTY	ITEM	MATERIAL	PART #/ SPEC.
-	-	WHITE Al <sub>2</sub> O <sub>3</sub>	